

**INFINITY FARM**  
1899 N Cedar Lake Road  
Round Lake Beach, IL 60073

*Infinity  
Farm*



**Horse Show at**



**MAY 29-31, 2026**

*Featuring:*

Trainer Incentive Program

***\$500 Hunter Masquerade***

***\$1,000 Hunter Derby***

**ENTER ONLINE AT: [www.horseshowtime.com](http://www.horseshowtime.com)**



# NIHJA Horse Show 2026 OFFICIALS

Judge.....Diane Young – Belleville, IL  
 Judge.....Ashley Duda – Randolph, KS  
 Manager.....Nancy Zeis – Round Lake Beach, IL  
 Course Designer.....Dean Battaglia- Woodstock, IL  
 Show Secretary.....Jessica Battaglia  
 Office Staff.....Patrick Cannon-Bartholomew  
 Paddock Masters.....Kate McQueen, & Kristie Hohol

### Fees:

<b>Stalls:</b>	<b>\$ 170.00</b>	<b>RV Nightly</b>	<b>\$ 50.00</b>
<b>Classes:</b>	<b>\$ 25.00</b>	<b>Office</b>	<b>\$ 35.00</b>
<b>Hunter Classics:</b>	<b>\$ 35.00</b>	<b>Non-Member</b>	<b>\$ 50.00</b>
<b>Shavings</b>	<b>\$ 11.00</b>	<b>Derbies</b>	<b>\$ 50.00</b>
<b>Trailer In Fee: per day</b>	<b>\$ 75.00</b>	<b>Medic Fee:</b>	<b>\$ 25.00</b>
<b>Non-Showing Horses: \$100.00 + applicable fees</b>			

*\$20 stall discount will be awarded to entries received at [www.horseshowtime.net](http://www.horseshowtime.net) by 5/20/26*

For Stall, Shavings Reservations

Call or text

Jess Battaglia 815-245-0242

Enter online at: [www.horseshowtime.com](http://www.horseshowtime.com)

Email entries to: [VictoriousFarm@yahoo.com](mailto:VictoriousFarm@yahoo.com)

All horses are required to have a current Negative Coggins certificate & proof of vaccinations within 6 months.

**For Internet Directions use the following address:**

**28426 98th Street, Trevor, WI 53179**

**Directions:** From Richmond, IL take Rt. 173 to Wilmot Rd. Turn north on Wilmont Rd. into the town of Wilmot. At the second stop sign, turn right or east on C. Go ½ mile and turn left or North on B. Go 1 ½ mile to AH. Turn right on AH. Silverwood is ½ mile on left.

From I94 in Illinois head north to Rt. 173. Exit and go west on Rt. 173 to Rt. 45. Turn North or right on Rt. 45. Take Rt. 45 north into Wisconsin to Hwy. C. Turn West or left on C to Rt. 83. Turn North or right on Rt. 83 and go 1/3 mile to SA. Turn left on SA and go 1 ½ mile to T intersection. Turn left at T intersection which is AH. Silverwood is ½ mile on right.



### LODGING:

#### Hotels

Best Western Executive Suites in Pleasant Prairie.....262-857-7699  
 Hampton Inn & Suites Pleasant Prairie.....262-358-9800  
 La Quinta Pleasant Prairie.....262-857-7911  
 Doubletree by Hilton Pleasant Prairie.....262-857-3377

#### Camping

Chain O'Lakes State Park.....847-567-5512  
 Happy Acres in Bristol.....262-857-7373

# 2026 NIHJA Horse Show

## Rules and Regulations

- USEF rules apply if not covered by NIHJA.
- Trophies and Ribbons in all classes. Champion and Reserve for all divisions.
- You must be entered in the entire division to be eligible for Championships and Reserve Championships.
- USEF Approved Hard hat must be worn at all times.
- Horses may arrive after 10:00 a.m. Thursday, May 28.
- Management reserves the right to cancel or combine classes.
- Non-stabled horses pay \$75/day trailer in fee.
- Please leave dogs at home. If not, a short leash and responsible handler is mandatory. \$50 fine for loose dogs.
- Stall requests final by 5:00 pm Sunday, May 24. Trainers and owners are responsible for stalls not cancelled by this deadline.
- There will be a charge of \$50 for returned checks.
- Shaving orders must be received by 2 pm each day in the secretary office. (No refund for unused shavings, no outside shavings allowed)
- Do not deface stalls in any way. (Competitors responsible for stall damage)
- There will be a \$50 fee for returned checks
- Horses must be entered in 4 classes to avoid the non showing horse fee.

## SCHOOLING SCHEDULE

*~Weather Pending~*

**Thursday: 11 AM-7 PM**

**Friday: Until 1 hour before show begins**

**Saturday: Until 1 hour before show begins**

**Sunday: No Schooling**



RIDERS BOUTIQUE

761 NORTH 17TH STREET. UNIT 26 ST. CHARLES IL 60174

[www.riders-boutique.com](http://www.riders-boutique.com)

**\*\*\*NEW for 2026\*\*\***



*Puddle Hunter & Puddle Equitation!*

18" Verticals over a Full Course  
88-90 Puddle Hunters  
154-156 Puddle Equitation

*Jumper Classics!*

251 2'3" Jumper Classic  
252 2'6" Jumper Classic  
253 2'9" Jumper Classic  
254 3'0" Jumper Classic

**Class 221 ÷ \$500 Infinity Hunter Spectacular**

**Class 222 ÷ \$1,000 Hunter Derby**

The first round of the Spectacular/Derby will be a classical hunter round that receives a numerical score. The top 12 horses and riders will return for a second handy hunter round. The scores from both rounds will be totaled. All horses must be entered in one entire hunter division to be eligible to compete the spectacular/derby. 2', 2'6", or 3'

For the DEVOUCOUX derby, in addition to \$1,000 prize money divided amongst the top placing horses, Devoucoux will award special prizes to 1<sup>st</sup>, 2<sup>nd</sup>, and 3<sup>rd</sup> Place!

**Ribbons through 12<sup>th</sup> place, riders MUST ride for ribbons to receive prize money**



## **Become a Sponsor!**

**NIHJA is looking for individuals, families, or businesses to sponsor a division for our annual Awards Banquet!**

**Your sponsorship will help support the riders and horses of the NIHJA circuit by providing quality awards and prizes that are distributed during the banquet on November 21.**

**Please e-mail**

**[sponsorship@nihja.net](mailto:sponsorship@nihja.net)**

**To Sign Up!**

BIARRITZ  
**DEVOUCOUX**  
FRANCE



FARM  
**RANCH**  
TEAM

**ALEXIS CLANCY- SFR**

Alexis specializes in pairing clients with their dream equestrian property. Keep your horse's needs a priority

- ☎ 224-800-4778
- ✉ alexis@farmranchteam.com
- 📍 3737 W. Elm St, Mchenry IL
- 🌐 www.farmranchteam.com

21 | FARM & RANCH



BLUE RIBBON HOME INSPECTIONS

BLAKE CLANCY 847-840-8086  
FULLY LICENSED & INSURED

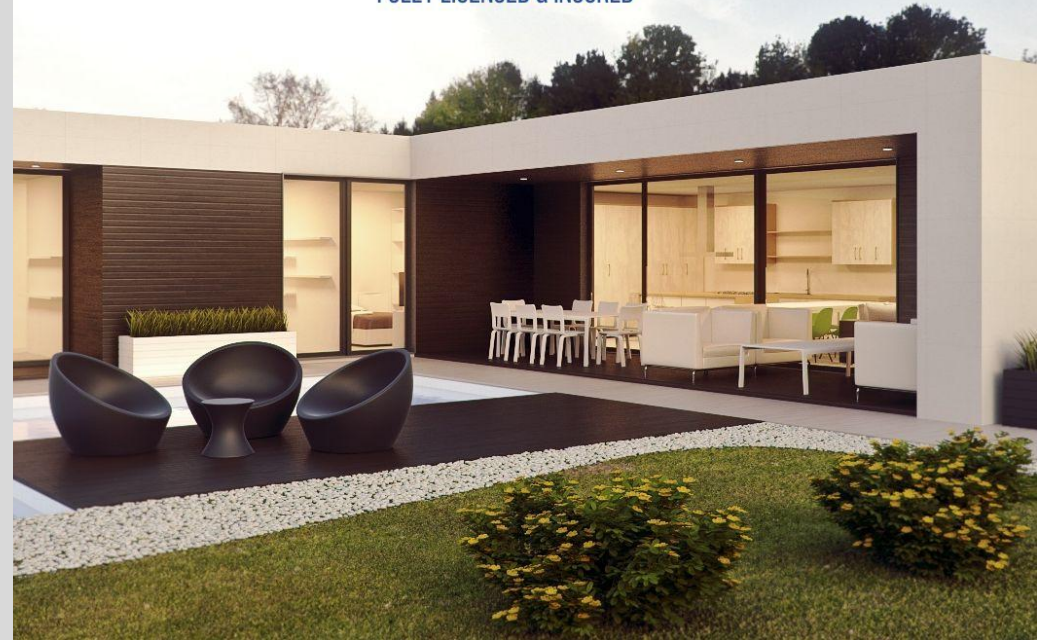

Official Show Photographer



Please preview photos early during the show to avoid long lines on Sunday!

# Trainer Incentive Program!

All trainers that reserve 5 or more stalls per show are then eligible to bring 1 additional horse under the Trainer Incentive Program. This horse will be charged the \$100 program fee plus the cost of any hay, shavings, etc. The program fee covers the stall, office/medic fee, and all class entry charges. Program horses may participate in the Hunter Spectacular and Derby but will not be eligible to receive prize money.

## **In order to participate-**

**\*Horse MUST be owned by trainer or farm**

**\*Horse may ONLY compete in classes open to professionals. (But not required to be ridden by a professional) If the horse competes in any classes restricted to non-pros, incentive will be canceled, and all regular show fees will then be applied.**



# Healthcare & Commercial Interior Design Services

- Concept Design & Branding
- Design Development
- Color & Finish Selection
- Furniture & Fixture Selection
- Test Fits & Space Planning

## Book Now at

[www.foersterdesignstudio.com](http://www.foersterdesignstudio.com)

## More Details

[lauren@foersterdesignstudio.com](mailto:lauren@foersterdesignstudio.com)

314.795.2469

Virtual Services Available

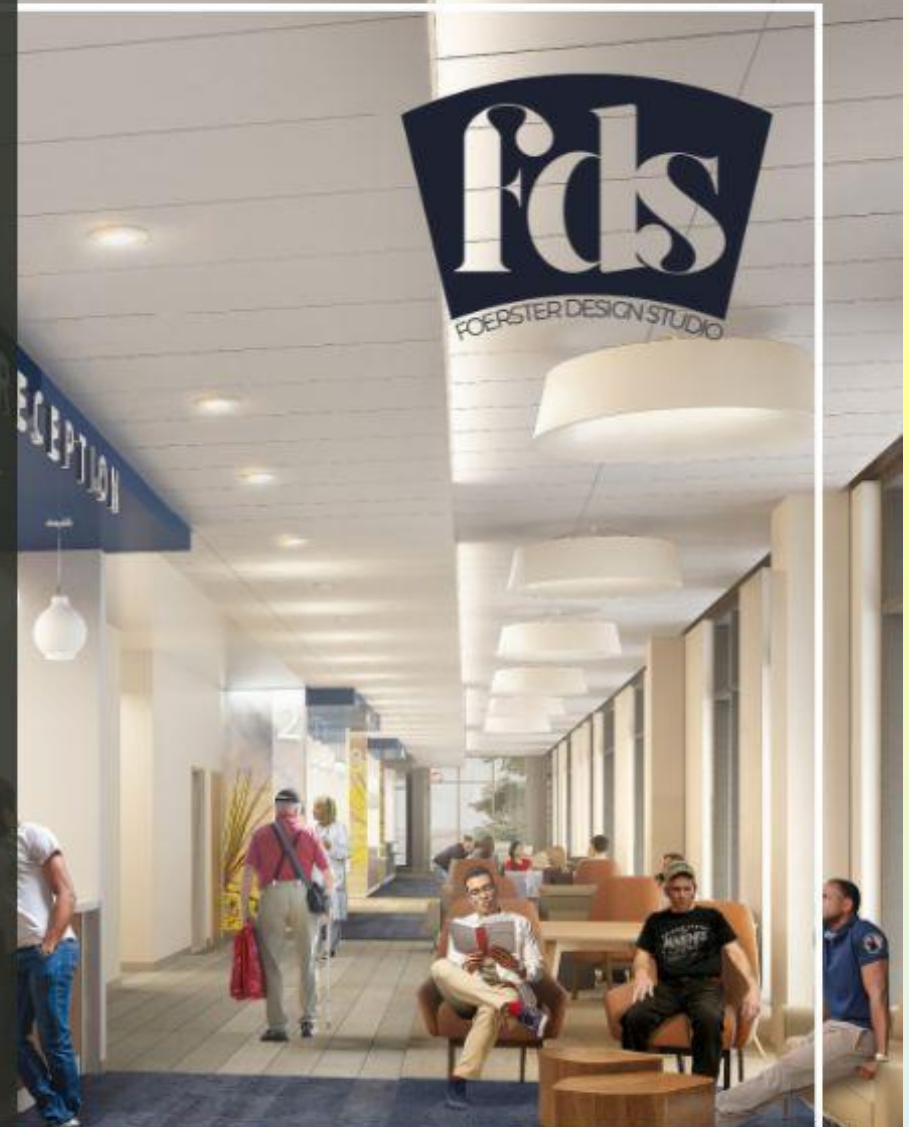

# INFINITY NIHJA 2026 ENTRY FORM



Horse Name: \_\_\_\_\_

Trainer Name: \_\_\_\_\_

Owner: \_\_\_\_\_

Address: \_\_\_\_\_

City/State/Zip: \_\_\_\_\_

Phone: \_\_\_\_\_ Classes: \_\_\_\_\_

Rider #1 \_\_\_\_\_

Address: \_\_\_\_\_

City/State/Zip: \_\_\_\_\_

Phone: \_\_\_\_\_ Classes: \_\_\_\_\_

Rider #2 \_\_\_\_\_

Address: \_\_\_\_\_

City/State/Zip: \_\_\_\_\_

Phone: \_\_\_\_\_ Classes: \_\_\_\_\_

**WARNING: Under the Equine Activity Liability Act, each participant who engages in an equine activity expressly assumes the risks of engaging in and legal responsibility for injury, loss, or damage to person or property resulting from the risk of equine activities.” (Senate Bill 240-IL)**

A person who is engaged for the compensation in the rental of equines or equine equipment or tack or in the instruction of a person in the riding or driving of an equine or in being a passenger upon an equine is not liable for the injury or death of a person involved in equine activities resulting from the inherent risks of equine activities, as defined in section 895.481(1)(e) of the Wisconsin Statutes. The undersigned agrees to hold NIHJA, Silverwood Farm, LLC, Lisa Froehlig, Nancy Zeis, Infinity Farm, and employees of Infinity & Silverwood Farm harmless for lost, damaged or stolen property and for injury to horses, exhibitors or spectators before, during and after the horse show.

Exhibitor/Agent Signature: \_\_\_\_\_

Exhibitor #2 Signature: \_\_\_\_\_

Permission for Minor to Show: \_\_\_\_\_

Trainer Signature: \_\_\_\_\_

Stable With: \_\_\_\_\_

Make checks payable to: INFINITY FARM

CLASSIFICATION	Height	Class Nos.					NO. _____		
Ground Poles Equitation	Poles	115	116						
Crossrails	x's	117	118						
Short/Long Stirrup Equitation	x's Short	119	120	121	Long	122	123	124	
Rusty Stirrup Equitation	x's	125	126			127			
Puddle Equitation	18"	154	155			156			
Beginner Equitation	2'0" Child	128	129		Adult	130		131	
Limit Equitation	2'3" Child	132	133		Adult	134		135	
Pony Equitation	2'-2'6"	136	137						
Mod. Equitation	2'6" Child	138	139		Adult	140		141	
Jr. Equitation	2'9"-3' Low	144	145		High	146		147	
Amateur Adult Equitation	2'9"	142	143						
NIHJA Children's Mini-Medal	2'3"	152							
NIHJA Adult Mini-Medal	2'6"	153							
NIHJA Children's Medal	2'9"	151							
NIHJA Sr. Medal	3'0"	150							
NIHJA Jr. Medal	3'3"	149							
Lead Line		148							
GP/Crossrail Equitation Classic	Poles/x's	213							
Short/Long/Rusty Stirrup Equitation Classic	1'6"	214							
Beginner Equitation Classic	2'	215							
Pony/Limit Equitation Classic	2'3"	216							
Modified Ch./Ad Equitation Classic	2'6"	217							
Junior/Amateur Adult Equitation Classic	2'9"-3'	219							
<b>JUMPERS</b>									
Puddle Jumpers	2'3"	97		98		99			
Schooling Jumper	2'6"	100		101		102			
Low Jumper	2'9"	103		104		105			
Training Jumper	3'0"	106		107		108			
High Training Jumper	3'3"	109		110		111			
Combined Jumper	3'6"	112		113		114			
Jumper Classics	2'3"-3'	251		252		253		254	
<b>HUNTER</b>									
Ground Pole Hunters	Poles	34		35		36			
Crossrail Hunters	x's	37		38		39			
Short/Long Stirrup W.H.	x's Short	40	41	42	Long	43	44	45	
Rusty Stirrup W.H.	x's	85		86		87			
Puddle Hunter	18"	88		89		90			
Beginner W.H.	2'0" Child	46	47	48	Adult	49	50	51	
Novice W.H.	2'3"	22		23		24			
Limit W.H.	2'3" Child	52	53	54	Adult	55	56	57	
Pony W.H.	2'0"-2'6"	58		59		60			
Schooling Hunter	2'0"	1		2		3			
Open 2'6" W.H.	2'6"	91		92		93			
Pre-Green W.H.	2'6"	7		8		9			
Training W.H.	2'6"	4		5		6			
Maiden W.H.	2'6"	61		62		63			
Mod. W.H.	2'6" Child	64	65	66	Adult	67	68	69	
Low W.H.	2'9"	10		11		12			
Non-Pro W.H.	2'9"	70		71		72			
Non-Thoroughbred W.H.	2'9"	13		14		15			
Thoroughbred W.H.	2'9"	16		17		18			
Adult W.H.	2'9"	73		74		75			
Low Junior	2'9"	76		77		78			
Amateur Adult W.H.	3'0"	82		83		84			
High Jr. W.H.	3'0"	79		80		81			
Open W.H.	3'0"	19		20		21			
Small W.H.	3'0"	25		26		27			
Large W.H.	3'3"	28		29		30			
Regular W.H.	3'6"	31		32		33			
Hunter Warm-ups	varies	301	302	303	304	305	306	307	308 309 310
Open Hunter Classic	varies	200		201					
Ground Pole/Crossrail Classic	Poles/x's	202							
Short/Long/Rusty Stirrup Hunter Classic	1'6"	203							
Beginner Child/Adult Hunter Classic	2'0"	204							
Limit Child/Adult/ Pony Hunter Classic	2'3"	205							
Children's/Modified Hunter Classic	2'6"	206							
Modified/Maiden Hunter Classic	2'6"	207							
Junior Hunter Classic	2'9"-3'0"	208							
Adult Hunter Classic	3'0"	209							
\$500 Infinity Hunter Spectacular	2'-3'		221a - 2'0"	221b - 2'6"	221c - 3'0"				
\$1,000 Infinity Hunter Derby	2'-3'		222a - 2'0"	222b - 2'6"	222c - 3'0"				

For Stall Reservations call Jess Battaglia at 815-245-0242

Make checks payable to: INFINITY FARM

# Infinity Farm



# 2026 Schedule

**Class counts can be viewed at:**  
[www.horseshowtime.com](http://www.horseshowtime.com)

## Sunday - Ring 2 continued...

- 153 NIHJA Adult Mini Medal
- 141 Mod. Adult Eq. Flat
- 139 Mod. Children Eq. Flat
- 140\* Mod. Adult Eq. O/F
- 138\* Mod. Children Eq. O/F
- 217 Mod Ch/Ad Eq Classic

## Friday, 8:00 am - Ring 2

- 301 WARM-UP O/F**
- 1,2\* Schooling Hunter 2' O/F
- 3 Schooling Hunter 2' U/S
- 22,23\* Novice WH O/F
- 24 Novice WH U/S
- 4,5\* Training WH 2'6" O/F
- 7,8\* Pre-Green WH 2'6" O/F
- 6 Training WH U/S
- 9 Pre-Green WH U/S
- 10,11\* Low WH O/F
- 16,17\* TB WH O/F
- 13,14\* Non-TB WH O/F
- 12 Low WH U/S
- 18 TB WH U/S
- 15 Non-TB U/S
- 19,20\* Open WH O/F
- 25,26\* Small WH O/F
- 21 Open WH U/S
- 27 Small WH U/S
- 28,29\* Large WH O/F
- 30 Large WH U/S
- 31,32\* Regular WH O/F
- 33 Regular WH U/S
- 201 Open Hunter Classic**
- 221 \$500 Hunter Spectacular**
- 97 Puddle Jumpers 2'3"
- 251 Jumper Classic 2'3"**
- 100 Schooling Jumper 2'6"
- 103 Low Jumper 2'9"
- 253 Jumper Classic 2'9"**
- 106 Training Jumper 3'0"

## Friday, Ring 2 cont...

- 109 High Training Jumper 3'3"
- 112 Combined Jumper 3'6"
- Saturday, 8:00am- Ring 2**
- 98 Puddle Jumpers 2'3"
- 101 Schooling Jumper 2'6"
- 252 Jumper Classic 2'6"**
- 104 Low Jumper 2'9"
- 107 Training Jumper 3'0"
- 110 High Training Jumper 3'3"
- 113 Combined Jumper 3'6"
- 305 WARM-UP O/F**
- 67,68\* Mod. Adult WH O/F
- 64,65\* Mod. Child WH O/F
- 61,62\* Maiden WH O/F
- 206 2'6" Hunter Classic**
- 63 Maiden WH U/S
- 69 Mod. Adult WH U/S
- 66 Mod. Children's WH U/S
- 70,71 Non-Pro WH O/F
- 73,74\* Adult WH O/F
- 209 Adult Hunter Classic**
- 76,77\* Low Junior WH O/F
- 208 Junior Hunter Classic**
- 75 Adult WH U/S
- 78 Low Junior WH U/S
- 79,80\* High Junior WH O/F
- 208 Junior Hunter Classic**
- 82,83\* Amat. Adult WH O/F
- 209 Adult Hunter Classic**
- 72 Non-Pro WH U/S

## Saturday - Ring 2 continued...

- 84 Amat. Adult WH U/S
- 81 High Junior WH U/S
- 222 \$1,000 Infinity Hunter Derby**
- Saturday 8:00 am - Ring 1**
- 303 WARM-UP C/S/L/R Only**
- 34,35\* Ground Pole Hunters O/P
- 37,38\* Crossrail Hunters
- 202 G/P/C Hunter Classic**
- 36 Ground Pole Hunter U/S
- 39 Crossrail Hunter U/S
- 40,41\* Short Stirrup WH O/F
- 43,44\* Long Stirrup WH O/F
- 85,86\* Rusty Stirrup WH O/F
- 203 S/L/R Stirrup Hunter Classic**
- 42 Short Stirrup WH U/S
- 45 Long Stirrup WH U/S
- 87 Rusty Stirrup WH U/S
- 304 WARM-UP 2' - 2'6"**
- 46,47\* Beg. Children WH O/F
- 49,50\* Beg. Adult WH O/F
- 204 Beg. Hunter Classic**
- 48 Beg. Children WH U/S
- 51 Beg. Adult WH U/S
- 58,59\* Pony WH O/F
- 205 Pony/Limit Hunter Classic**
- 60 Pony WH U/S

## Saturday - Ring 1 continued...

- 52,53\* Limit Children WH O/F
- 55,56\* Limit Adult WH O/F
- 205 Pony/Limit Hunter Classic**
- 54 Limit Children WH U/S
- 57 Limit Adult WH U/S
- 88,89 Puddle Hunter 18" O/F
- 90 Puddle Hunter U/S

## Sunday, 8:00 am - Ring 2

- 99 Puddle Jumpers 2'3"
- 102 Schooling Jumper 2'6"
- 105 Low Jumper 2'9"
- 108 Training Jumper 3'0"
- 254 Jumper Classic 3'0"**
- 111 High Training Jumper 3'3"
- 114 Combined Jumper 3'6"
- 148 Lead Line
- 149 NIHJA Junior Medal
- 150 NIHJA Senior Medal
- 151 NIHJA Children's Medal
- 308 WARM - UP O/F**
- 142\* Amateur Adult Eq. O/F
- 144\* Low Junior Eq. O/F
- 219 Jr/Am Adult Eq Classic**
- 143 Amateur Adult Eq. Flat
- 146\* High Junior Eq. O/F
- 145 Low Junior Eq. Flat
- 147 High Junior Eq. Flat
- 152 NIHJA Children's Mini Medal

## Sunday - 8:00 am - Ring 1

- 306 G/C/S/L Stirrup WARM-UP**
- 115\* Ground Pole Eq O/P
- 117\* Crossrail Eq. O/F
- 213 GP/Crossrail Eq Classic**
- 116 Ground Pole Eq W-T
- 118 Crossrail Eq. W T
- 120 Short Stirrup Eq. W-T
- 121 Short Stirrup Eq. W-T-C
- 123 Long Stirrup Eq. W-T
- 124 Long Stirrup Eq. W-T-C
- 126 Rusty Stirrup Eq W-T
- 127 Rusty Stirrup Eq W-T-C
- 119\* Short Stirrup Eq. O/F
- 122\* Long Stirrup Eq. O/F
- 125\* Rusty Stirrup Eq. O/F
- 214 Sh/Lg/R Stirrup Eq Classic**
- 129 Beg. Children's Eq. Flat
- 131 Beg. Adult Eq. Flat
- 307 WARM-UP O/F**
- 128\* Beg. Children Eq. O/F
- 130\* Beg. Adult Eq. O/F
- 215 Beginner Eq Classic**
- 133 Limit Children's Eq. Flat
- 135 Limit Adult Eq. Flat
- 137 Pony Eq. Flat
- 132\* Limit Children's Eq. O/F
- 134\* Limit Adult Eq. O/F
- 136\* Pony Eq. O/F
- 216 Pony/Limit Equitation Classic**
- 154,155 Puddle Equitation 18" O/F
- 156 Puddle Eq Flat

**\*The last class of each section will count as their first Classic round**

